



Hôtel Salé, façade jardin O.F. Campoverde- Musée national Picasso-Paris

## Welcome to the Musée national Picasso-Paris!

### The museum

Opened in 1985, the Musée national Picasso-Paris holds the world's largest collection of Pablo Picasso's work. It is located in the Marais district in the heart of Paris, inside the hôtel Salé, built between 1656 and 1660, and has been a protected historical monument since 1968.

### The collection

The collection of the Musée national Picasso-Paris is the result of two donations made to the State by Pablo Picasso's heirs in 1979, and later Jacqueline Picasso's heir in 1990. It has been enlarged by donations from Picasso's private collection and archives. Encompassing all the artistic movements and themes of Picasso's work, the collection also explores the artist's creative process through drawings, studies, sketches and sketchbooks, engravings, photographs, illustrated books, films and more.

### Level -1 "Discovery" space

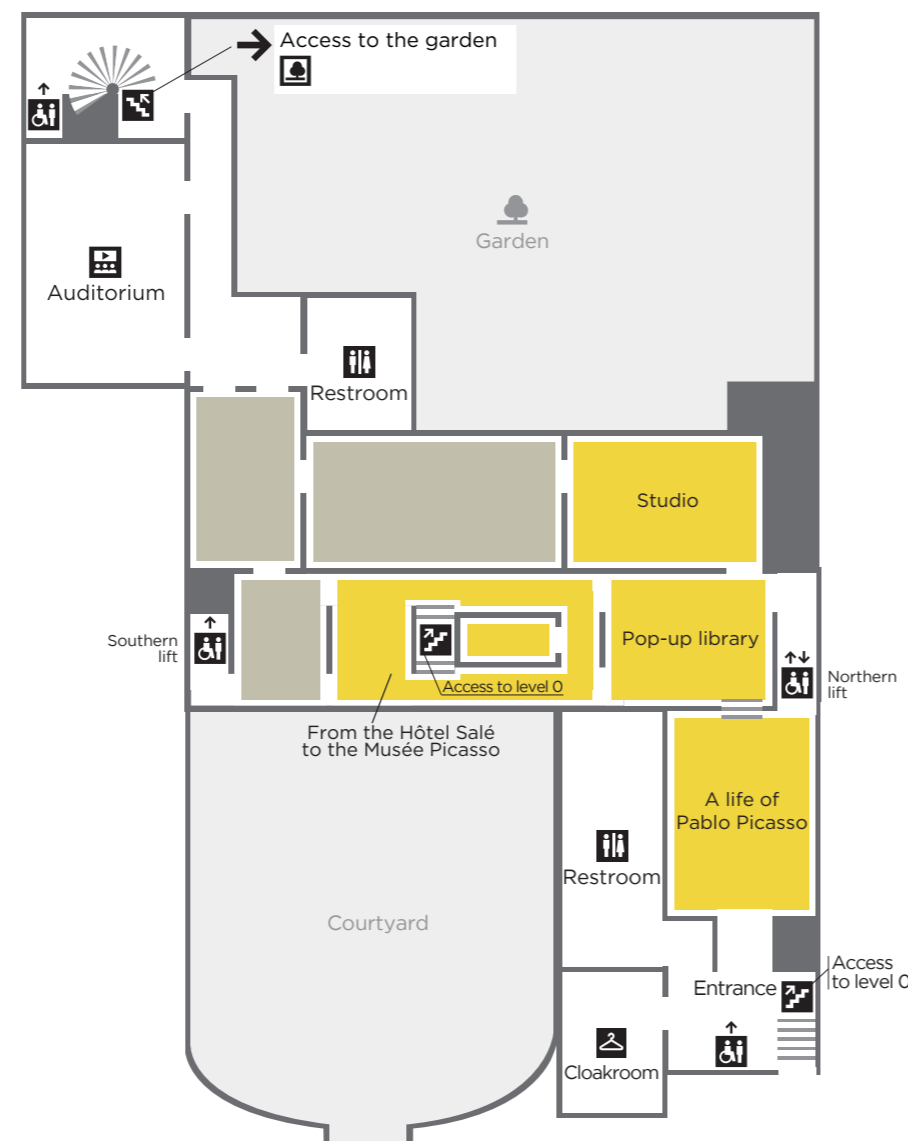

### Level 0 Picasso-Rodin Until January 2<sup>nd</sup> 2022



### Level 1 Picasso-Rodin Until January 2<sup>nd</sup> 2022



CURRENT EXHIBITIONS  
2021- 2022

PICASSO-RODIN

PICASSO. LECTURES,  
RELECTURES

Join us



www.museepicassoparis.fr

CONTACT

Telephone: +33 1 85 56 00 36  
contact@museepicassoparis.fr

## Level 2

Picasso. Lectures, relectures

The Musée national Picasso-Paris collection

Until September 5<sup>th</sup> 2021

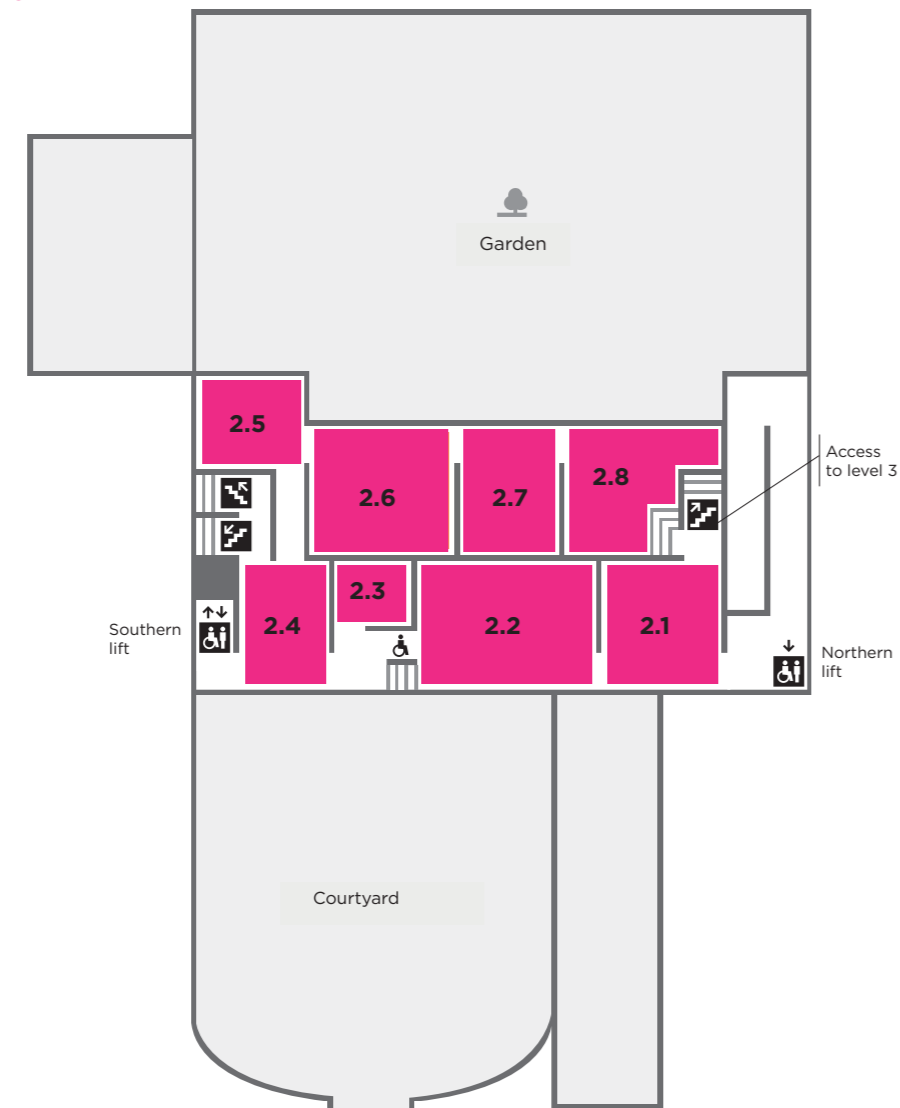

## Level 3

Picasso. Lectures, relectures

The Musée national Picasso-Paris collection

Until September 5<sup>th</sup> 2021

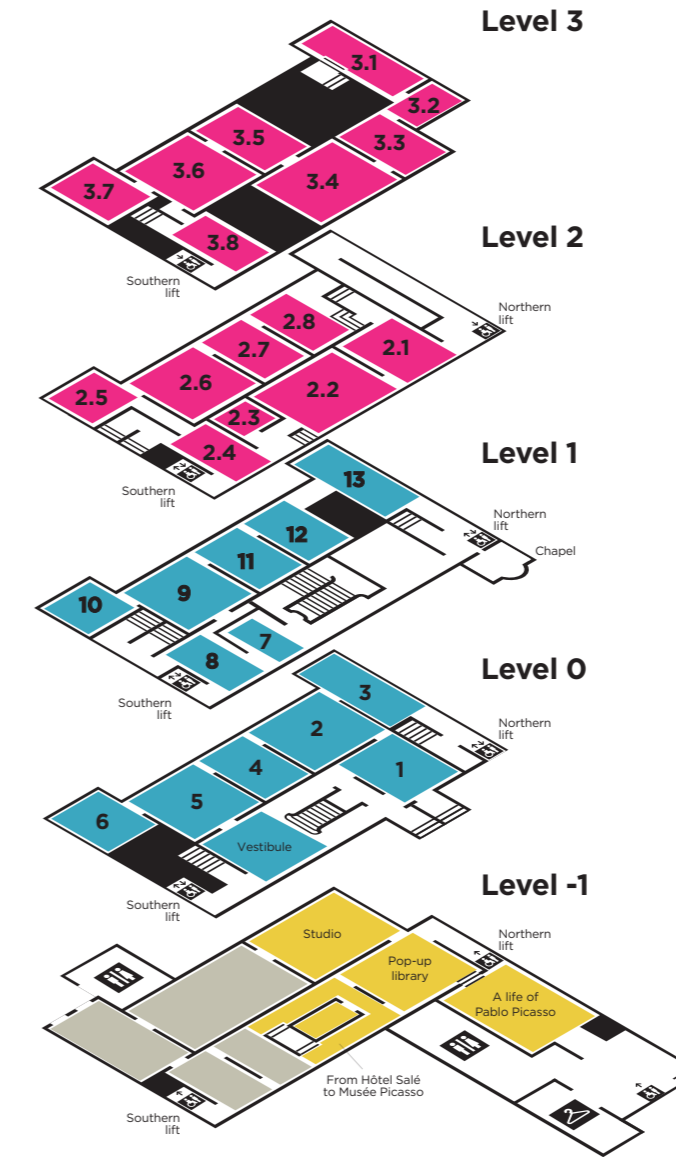
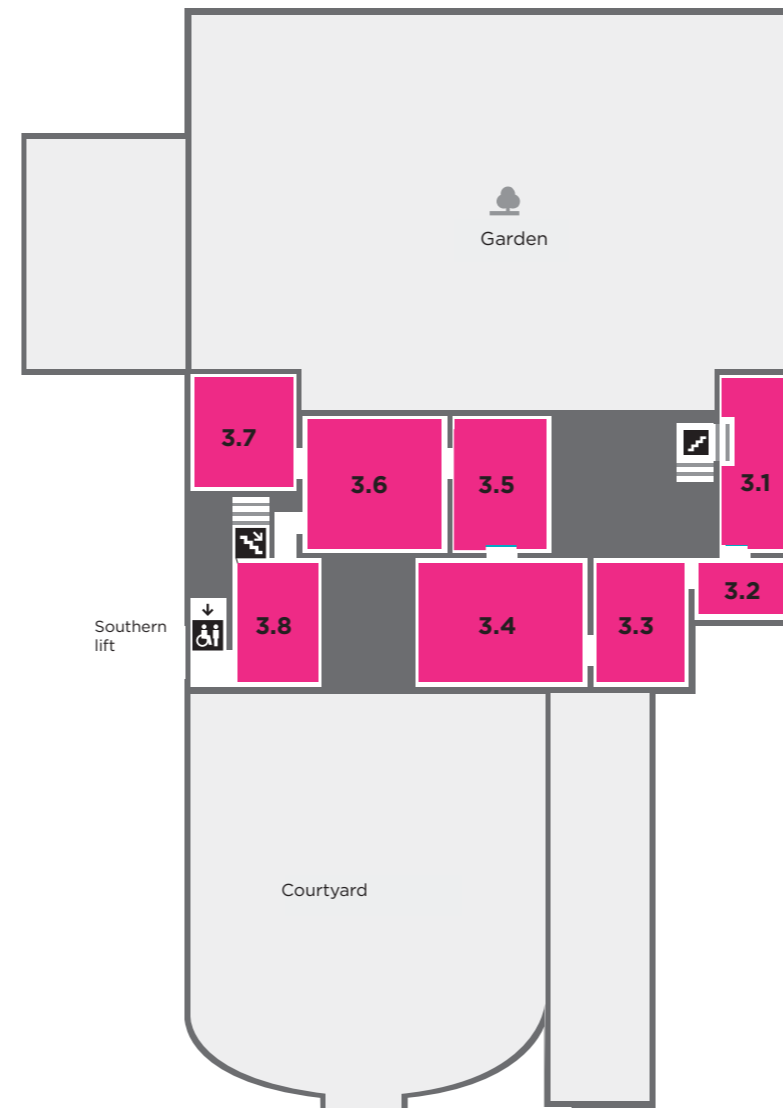

## Practical information

### PRICES

#### Museum entry

We recommend that you book your ticket in advance at [www.museepicassoparis.fr](http://www.museepicassoparis.fr)

Full price: €14  
Reduced price: €11

Take advantage of a special rate with the twin ticket!

Single fare: €21

Ticket valid for three months from the date of purchase, within the limit of the duration of the exhibition.

Ticket for priority access to the Musée national Picasso-Paris and the Musée Rodin.

#### Free entry

Granted upon presentation of proof of eligibility (list of accepted documentation available on the museum website).  
On the 1st Sunday of every month, museum entry is free for everyone.

#### Audioguide

Available in French, English, Spanish, German and Chinese.

Full price: €5  
Reduced price: €4

Recommended booking on [www.museepicassoparis.fr](http://www.museepicassoparis.fr)

### SERVICES

#### Cloakrooms

Cloakrooms are available on level -1 of the museum.

#### Restroom

Restroom is located on level -1.

#### Accessibility

The museum is accessible to people with reduced mobility.

#### Equipment for loan

Wheelchairs, pushchairs and folding chairs can be loaned to you, free of charge, in exchange for a form of ID. Please go to the museum's reception desk.

#### Bookshop

Open during museum hours.

### VISITS AND ACTIVITIES

The museum offers many visits and activities for both adults and children.

For more information, go to [www.museepicassoparis.fr](http://www.museepicassoparis.fr) or ask at the information desk in the entrance hall.

### OPENING HOURS

Tuesday to Friday: 10:30am to 6pm.  
Weekends and French Holidays: 9:30am to 6pm.  
Closed on Mondays, 25th December, 1st January and 1st May.

Last entrance to the Museum at 5:15 p.m.  
Closing begins at 5:40 p.m.

Due to the health crisis, these data may be subject to change. Please consult the website for opening hours.

### PICASSO PASS

To enjoy unlimited access and to avoid waiting in line at the museum, as well as a number of other benefits at the museum and our partner institutions, become a Member of the Musée national Picasso-Paris! All the information on our website in the section: **Réservations / Individuels / Adhésion Picasso Pass**

Maintain physical distance and respect safety guidelines.

Face masks are required for all visitors over 11 years old. Please don't forget to bring your own.

Hand sanitizer will be available at regular intervals during your visit.

The frequency of cleaning has been increased throughout our spaces to guarantee a safe visit.



# MAP MUSÉE NATIONAL PICASSO- PARIS

PICASSO

MuséePicassoParis